

2010 Florida Annual Statewide Prevention Conference



*Different Roles, Common Goals,
Advancing Prevention, Empowering Lives*

LEAD STRONG

**Sponsor & Exhibitor
Brochure**

September 29 - October 1, 2010 | Rosen Centre Hotel, Orlando

Message from the Director

Florida's 23rd Annual Statewide Prevention Conference is being held September 29 - October 1, 2010. Drawing over 700 attendees, this three-day event attracts professionals from various fields to learn about the latest research, best practices, and strategies to prevent public health threats and promote healthy communities and lives.

The health and wellness of Florida's citizens are essential to the success of our state. Substance abuse, violence, suicide, compulsive gambling, and mental health problems are among the issues that reduce quality of life, weaken communities, place added burdens on medical and judicial systems, and strain the resources of businesses.

Preventing these issues improves quality of life for Floridians, increases business productivity and growth, and contributes positively to the economy. Supporting prevention provides a valuable return on investment that allows our state and its citizens to flourish and thrive.

The Statewide Prevention Conference is a critical vehicle to address these issues. Please take part in improving the lives and communities of the state of Florida by sponsoring this event. There are several levels of sponsorship and all contributions are tax deductible. Qualified in-kind donations (advertising, printing, supplies, etc.) can substitute for monetary contributions.

On behalf of the Governor's Office and the greater prevention community, thank you for your support.

Sincerely,



Bruce D. Grant
Director, Florida Office of Drug Control
Executive Office of the Governor



Mission

The Florida Prevention Partnership is an alliance of state government agencies and non-profit organizations dedicated to building **HEALTHY COMMUNITIES** throughout Florida through preventing substance abuse, violence, crime, suicide, and compulsive gambling. One of the primary goals of the partnership is to sponsor and produce the Annual Florida Statewide Prevention Conference which brings these organizations together with front-line educators, providers, community partners and good corporate citizens to learn, teach, network and plan for the future of Florida. The following organizations are proud members of the Florida Prevention Partnership:

[Executive Office of the Governor/Office of Drug Control](#)

[Executive Office of the Governor/Statewide Office of Suicide Prevention](#)

[Florida Department of Children and Families](#)

[Florida Department of Education](#)

[Florida Department of Health](#)

[Florida National Guard](#)

[Florida State University/Center for Prevention Research](#)

[Florida Department of Corrections](#)

[Florida Department of Business and Professional Regulation/
Division of Alcoholic Beverages and Tobacco](#)

[Florida Highway Patrol](#)

[Florida Alcohol and Drug Abuse Association](#)

[Florida Council on Compulsive Gambling, Inc.](#)

[Florida Department of Juvenile Justice](#)

2010

Annual Statewide Prevention Conference | September 29 - October 1

Sponsorship Opportunities

Sponsorship Benefits

All packages include the following regular benefits:

- ◆ Inclusion in the on-site conference program provided to every registrant. (Estimated 700 attendees)
- ◆ Company logo with link on the conference website
- ◆ Company logo on the Entrance unit of the Exhibit Hall
- ◆ Company logo on 3' x 6' signs logistically displayed throughout the conference facility.
- ◆ Name badge ribbon with "Sponsor" designation

Sponsorship Packages

Community Sponsorships (\$1,000)

Contributing sponsors will receive all regular benefits.

Additional benefits include:

- Designation as a sponsor in the conference program
- One complimentary conference registration

Silver Sponsorships (\$3,000)

Silver sponsors will receive all regular benefits.

Additional benefits include:

- Advertisement (quarter-page, color) in the conference program
- Promotional insert, provided by you, for distribution with registration materials
- Complimentary (8 x 10 booth) in the Premier Sponsor area
- Two complimentary conference registrations

Exclusive silver opportunity:

Good Morning Breakfast Sponsor (\$3,000)

Gold Sponsorships (\$5,000)

Event sponsors will receive all regular benefits.

Additional benefits include:

- A brief welcome at the sponsored event
- Advertisement (half-page, color) in the conference program
- Promotional item, provided by you, to be placed at every seat during the sponsored event
- Complimentary (10 x 10 booth) in the Premier Sponsor area
- Three complimentary conference registrations
- One reserved table at sponsored event
- Special acknowledgement in conference program
- Company logo on exclusive signage at the sponsored event

Exclusive gold opportunities:

Opening Ceremony Sponsor (\$5,000)
Networking Lunch Sponsor (\$5,000)
Closing Ceremony Sponsor (\$5,000)

Exclusive Cyber Café Sponsorship (\$7,000)

The Cyber Café sponsor will receive regular and gold sponsorship benefits.

Additional benefits include:

- Designation as the exclusive Cyber Café sponsor in the conference program
- All computers set to your designated home page
- Computer screensavers set to your company logo or personalized message
- Prominently displayed company sign in the Cyber Café
- Promotional item, provided by you, to be distributed in the Cyber Café

Diamond Sponsorships (\$10,000)

Diamond sponsors will receive all regular benefits.

Additional benefits include:

- Your company logo displayed on the break-out session screens
- Advertisement (full-page, color) in the conference program
- Promotional insert, provided by you, for distribution with registration materials
- An e-mail blast to all conference attendees before the conference with information about the company and contact information.
- Complimentary (10 x 10 booth) in the Premier Sponsor area
- Five complimentary conference registrations
- One reserved table at all meal functions
- Special acknowledgement in conference program
- Post-show mailing list of all conference attendees

For the most up-to-date list of sponsorship options or to purchase a sponsorship, please contact CMC & Associates at 850-224-7775 or Meghan Wozniak at mwozniak@cmc-associates.com.

General Information

If your company markets to the prevention community, you'll want to join us for this collaborative event. Exchange with over 700 individuals ~ clinicians, community leaders, prevention professionals, law enforcement officers, educators and parents in attendance. This is an outstanding opportunity to network, build on existing relationships and establish new ones.

Location

The 2010 Annual Statewide Prevention Conference will be held at the:

Rosen Centre Hotel
9840 International Drive
Orlando, Florida 32819
Phone: 407-996-9840 Toll Free: 800-204-7234
Fax: 407-996-0865

Conference Management

If you have any questions relating to the exhibit or sponsorship program, please contact:

Meghan Wozniak
CMC & Associates
Phone: 850-224-7775
mwozniak@cmc-associates.com

Official Service Contractor

The official service contractor is Shepard Exposition Services. A complete service kit with shipping instructions for booth materials, electrical service, furnishings order forms, etc. will be sent to each exhibitor.

Exhibitor Benefits:

All exhibitors receive the following:

- ◇ An 8' x 10' booth (Gold and Diamond sponsors receive a 10' x 10' booth) equipped with an 8' high back drape and 36" high side dividers
- ◇ One 6' draped table, wastebasket and 2 chairs
- ◇ One company ID sign displaying the exhibitor's name and booth number
- ◇ Company listing in the conference program guide
- ◇ Conference registration for one person - (Any additional personnel who wish to participate in the conference workshops/sessions must register for the conference using the official registration form or on the website.)

Registration Deadline

A signed application for exhibit space must be received by September 1, 2010 to guarantee an exhibit booth at the conference. Exhibit booth reservations that remain unpaid after 21 days will be released back into inventory.

A floor plan is included in this brochure. Exhibitors may request preferred booth locations, however exhibit space will be assigned on a first-come, first-served basis.

Cancellation Policy

ANY CANCELLATION REQUESTS MUST BE IN WRITING and submitted by e-mail to Mwozniak@cmc-associates. Requests for refunds less \$100 administrative fee must be received by August 20, 2010. No refunds can be made after September 1, 2010.

Booth Prices

Early Exhibitor registration (On or before July 1, 2010)

Non-profit	\$ 500
Corporate	\$ 850

Late Exhibitor registration (After July 1, 2010)

Non-profit	\$ 600
Corporate	\$ 1000

For maximum exhibit traffic, the following will be held in the Exhibit Hall:

- ◇ Exhibitor reception on Wednesday, 5:30 p.m. – 7:00 p.m.
- ◇ AM & PM refreshment breaks

Terms & Conditions

Exhibit Space Assignment

Space is assigned on a first-come, first-served basis, determined by receipt of payment in full for booth space and a signed contract. CMC & Associates, agent for the 2010 Annual Statewide Prevention Conference, will confirm the receipt of payment and contract along with a booth assignment. Management reserves the right to re-arrange the floor plan where necessary to facilitate a successful traffic flow.

Standard Booths

All booths are 8' x 10' and will be equipped with an 8' high back drape and 36" high side dividers. Booths will be provided with a one 6' draped table, wastebasket, 2 chairs, and 1 company identification sign displaying the exhibitor's name and booth number.

Exhibition Hours

The exhibits will be open as follows:
Wed., Sept. 29, 2010 | 8:00 AM – 5:00 PM
Thurs., Sept. 30, 2010 | 8:00 AM – 5:00 PM

The Agency requires all exhibits to remain open, with representatives in attendance, during the specified exhibit hours.

Exhibit Hall Access

Exhibitor personnel will be permitted on the exhibit floor one hour prior to opening and may remain one hour after the daily closing of the exhibit hall, with the exception of Thursday, September 30, 2010, when dismantling begins.

Set-Up

Exhibitor set-up will take place on Tuesday, September 28, 2010 from 4:00 p.m. - 7:00 p.m. All crates, etc. must be off the exhibit floor and no trunks, cases, or other packaging materials are to be left in the exhibit area after set-up of the booth, nor may such materials be brought into the exhibit hall during open exhibit hours.

Any space not claimed and occupied, or for which no special arrangements have been made in writing to the Agency prior to June 1, 2010 at 3:00 p.m., shall revert to the Agency to be relet and occupied in any manner and for such purposes as the Agency may see fit. Neither the Agency nor Shepard Exposition Services, Inc. shall be responsible for any injury to person or damage to property incurred.

Break Down

Exhibitors are required to wait until the official closing time on Thursday, September 30, 2010, at 2:00 p.m. to break down exhibits, a show rule that will be monitored. Your cooperation is appreciated. The rights and privileges of an exhibitor shall not be infringed upon by any other exhibitor. The conference management reserves the right to restrict exhibits that may be objectionable or to order the removal of any portion of an exhibit, which in the judgment of the conference management company is detrimental to or detracts from the general order of the exhibits. This applies to persons advertising, soliciting, or anything of a similar nature.

Payment For Booth Space

Any person, partnership, or corporation engaging space who shall fail to make payment as herein provided shall thereby and thereupon forfeit all rights in and to the use of assigned space.

Liability

It is agreed that the Exhibitors shall indemnify and save harmless the 2010 Annual Statewide Prevention Conference, CMC & Associates, Shepard Exposition Services, Inc., and the Rosen Centre Hotel from all liability that might ensue from any cause whatsoever. Exhibitors are urged to take out a portal-to-portal rider available at a nominal cost on their own insurance policies, protecting them against loss

through theft, fire damage, etc. The Exhibitor is responsible for damage to property. No signs or other articles shall be posted, nailed or otherwise attached to any of the pillars, walls, doors, floors, etc., in such manner as to deface or destroy. Use of alcohol is prohibited.

Fire Regulations

In order to comply with local fire ordinance requirements, all decorative material must be flame resistant. Materials meeting these requirements are available to Exhibitors from Shepard Exposition Services, Inc. No volatile or flammable fluids, substances, or materials of any nature prohibited by city fire regulations or insurance carriers may be used in any booth.

Americans with Disabilities Act

Exhibitors are responsible for compliance with the Americans With Disabilities Act of 1992 for their booth space.

Function Space Requests

The Agency prohibits the scheduling of exhibitor events, including those for company personnel only, (whether they are business or social) at times which conflict with the Conference program activities.

2010 Statewide Prevention Conference

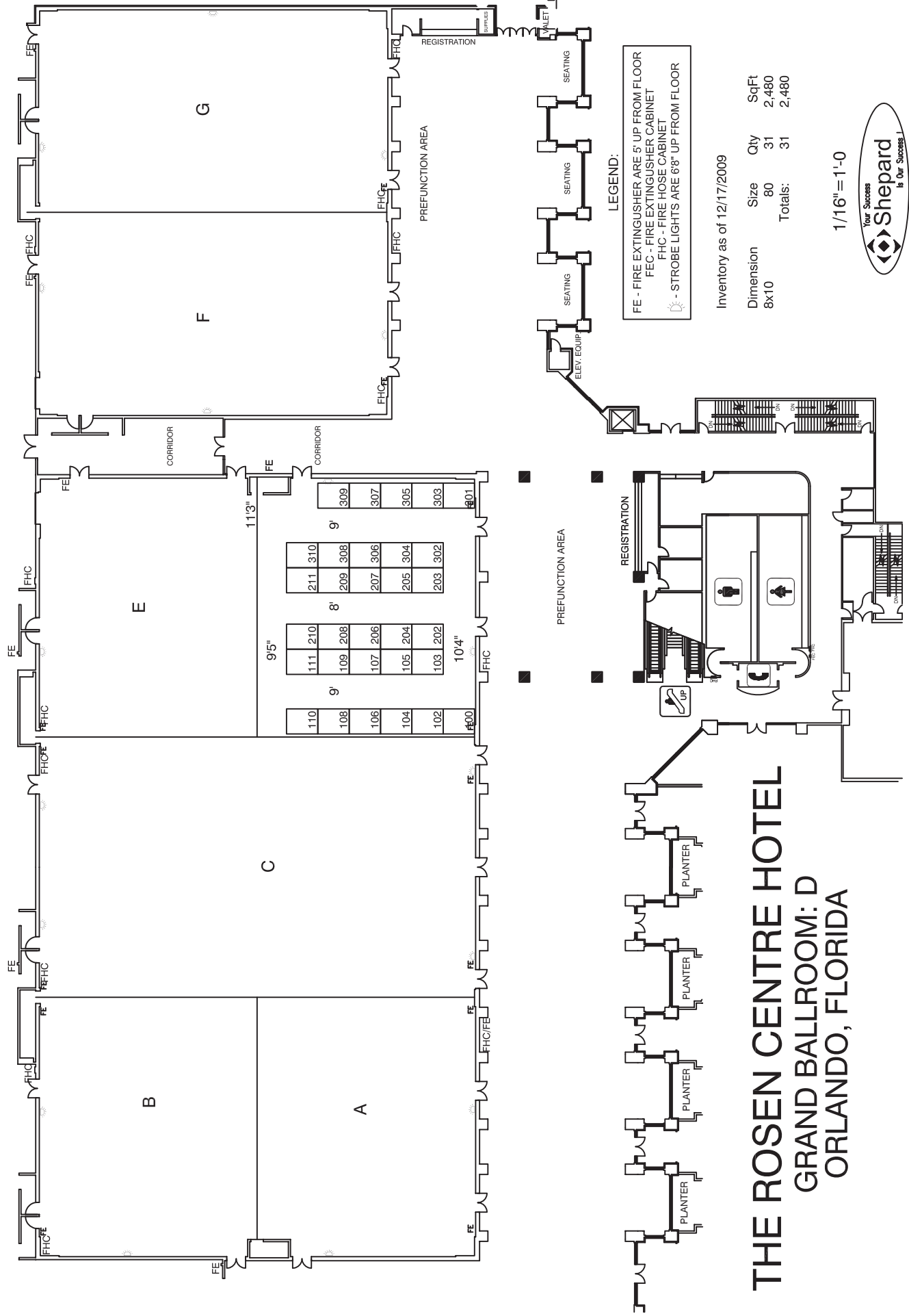

Sponsorship & Exhibit Application

2010 Annual Statewide Prevention Conference
September 29 - October 1 | Rosen Centre Hotel, Orlando

Due date: September 1, 2010

Company details to be listed in the Program Guide (exactly as it should appear)

company name _____
address _____
city _____ state _____ zip _____
telephone _____ fax _____
website address _____

Company representative to receive all information regarding the conference

name _____
address _____
city _____ state _____ zip _____
telephone _____ fax _____
email address _____

Yes, we will exhibit and we understand and agree that the conference management will attempt to assign our booth space among the following selections, but recognize that the assignment of booth space is at the sole discretion of CMC & Associates.

1. _____ 2. _____ 3. _____ 4. _____

Yes, sign us up as a Sponsor at the following level:

- Community - \$1,000 Silver - \$3,000 Gold - \$5,000
 Exclusive Cyber Cafe - \$7,000 Diamond - \$10,000

Contract submitted by

name _____ title _____
signature _____

Payment method

- VISA MasterCard AMEX check (payable to CMC & Associates)

credit card # _____ exp. date _____

name as it appears on card _____ signature _____

I agree to pay \$ _____ according to card issuer agreement.

EARLY REGISTRATION:
(On or before July 1, 2010)

Non-profit \$ 500
Corporate \$ 850

LATE REGISTRATION:
(After July 1, 2010)

Non-profit \$ 600
Corporate \$ 1000

To be included in initial booth assignments, a signed application must be received by conference management on or before September 1, 2010. Exhibit booth reservations that remain unpaid after 21 days will be released back into inventory. Submission of this Application does not guarantee allocation of a booth space.

Mail or Fax your completed application to:

CMC & Associates
2713 Blirstone Lane
Tallahassee, FL 32301
Fax 850.224.7704

Questions? Contact:
CMC & Associates
Toll-Free 888.320.6129

For Office Use Only:

Booth # _____

Payment Date: _____

Approved by: _____